

**** Please scroll down for parts list. ****

TD 2100 Electric Drawing #3

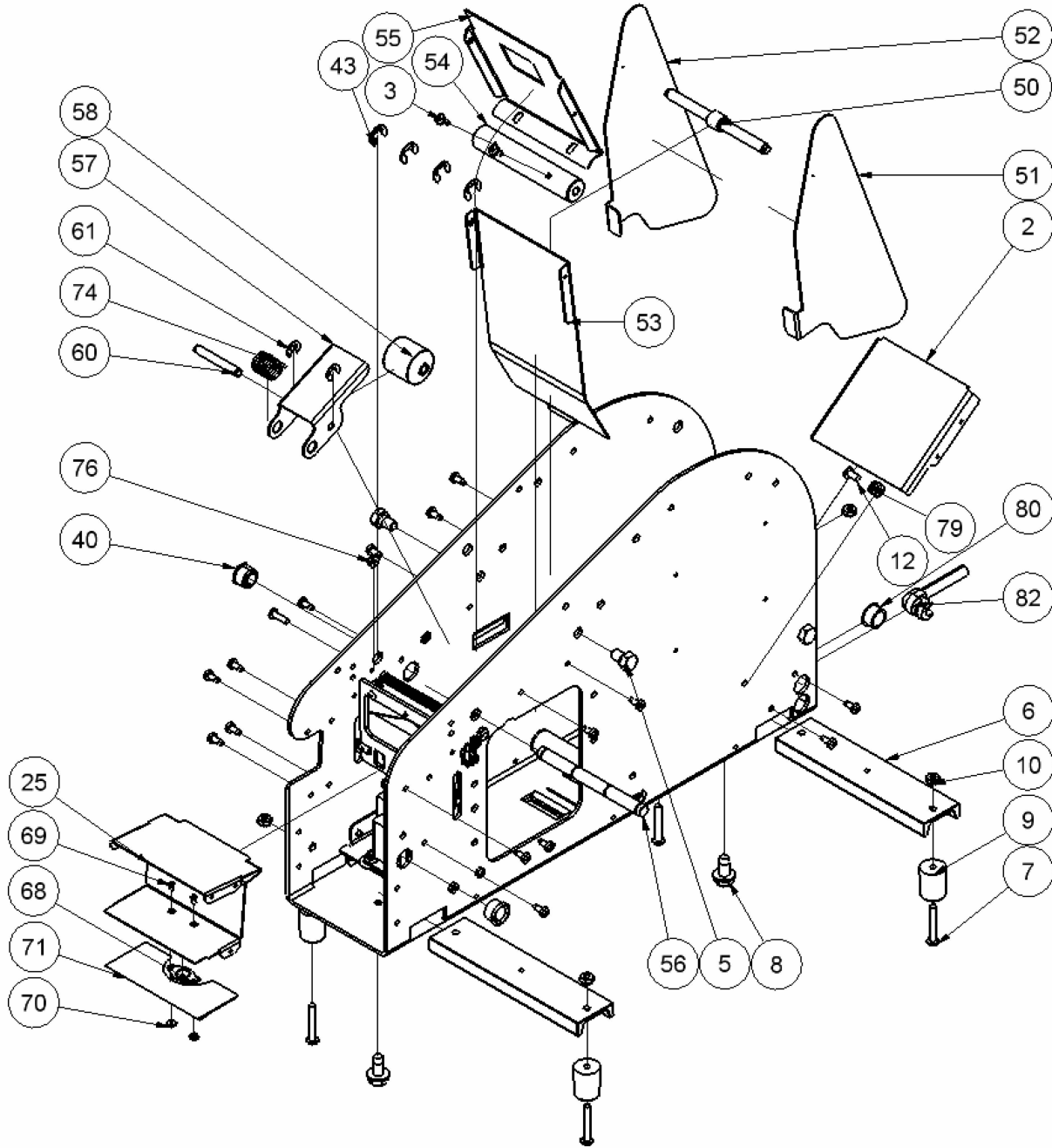

Replacement Part Table for
TD 2100 Electric Drawing #3

Replacement Part Number	Description	Item Number	Item Description	Quantity
RP40110	Foot Channel	6	Bar	1
		8	Screw	1
RP40115	Rubber Foot	9	Rubber Foot	1
		7	Screw	1
		10	Nut	1
RP40320	Tape Basket/Motor Cover	53	Aluminum Plate	1
		3	Screw	2
RP40515	Tape Channel Plate	55	Plate	1
		3	Screw	2
RP40540	Pinch Roll Assembly	60	Pin	1
		74	Spring	2
		61	E-Clip	2
		56	Shaft	1
		57	Holder	1
		58	Roll	1
RP40550	Tape Guide Assembly	50	Turnbuckle	1
		51	Guide RHS	1
		52	Guide LHS	1
RP40560	Dead Roller	54	Roll	1
		5	Screw	2
RP42956	90° Strain Relief	82	Power Cord Relief	1
RP42957	Dome Plug	80	Plug	1
RP42958	Split Bushing	126	Split Bushing	1
RP42978	Heater/Thermostat Assembly 110V	25	Water Tank Holder	1
		68	Thermostat 110V	1
		69	Screw	2
		70	Nut	2
		71	Heater 110V	1
		3	Screw	7
		NS	Wire	
		NS	Wire Connections	
RP42977	Thermostat Assembly 110V	68	Thermostat	1
		69	Screw	2
		70	Nut	2
		NS	Wire	
		NS	Wire Connections	
RP42810	Heater/Thermostat Assembly 220V	25	Water Tank Holder	1
		68	Thermostat 220V	1
		69	Screw	2
		70	Nut	2
		71	Heater 220V	1
		3	Screw	7
		NS	Wire	
		NS	Wire Connections	